

WHITCHURCH- STOUFFVILLE MUSEUM

Members' Newsletter Spring 2011

Curator: Stephanie Foley
Program Coordinator: Krista Rauchenstein

Telephone: 905-727-8954 OR 1-888-290-0337

Fax: 905-727-1282
Manager of Culture and Museum Services: Dorie Billich

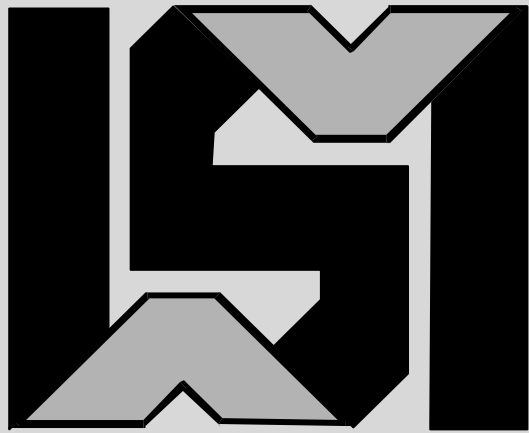

Around the Site

Full Steam Ahead!



We are getting more and more excited as we see progress continue for the new Visitor/Community Centre. There are pictures on the town's website that show the construction progress. (Check out [http://www.townofws.com/Visitor & Community Centre.asp](http://www.townofws.com/Visitor_&_Community_Centre.asp)). We had quite the celebration for the ground breaking and were lucky enough to have our MP Paul Calandra, MPP Helena Jacsek, the Mayor, and several of our Councillors here for the occasion.



Some highlights of the new building:

- ❖ The Main Hall – a multipurpose space that can hold up to 88 seated at tables for a dinner and up to 150 theatre style for a seminar or presentation. The large room can further be divided into two smaller spaces to allow more than one group to meet at the same time.
- ❖ A dedicated Research Room that will hold all (or most) of our archival information. Researchers can work here instead of in shared office spaces like before.
- ❖ Temporary Exhibition Gallery – This will provide a dedicated exhibit space. It will be temperature and humidity controlled to provide extra protection for the items on display.
- ❖ The Community Room – a space perfect for smaller groups to meet. It will have its own sink, coffee maker, etc, so it provides a self contained gathering space. The doors in this space open up into the basement foyer, doubling the circulation space for user groups.

- ❖ Hands-On/ Discovery Room (see sketch below) – this space will have “open storage” areas. There are horizontal and vertical drawers that can display small collections of items. There are also “hands-on baskets” that will hold written material and items inside for people to take out and handle. *More information in the fundraising update on the following page.*
- ❖ Collections Storage – This space will be temperature and humidity controlled. We will move many of our textiles and other more fragile and precious items to this room where they will have the best environmental conditions possible.
- ❖ Elevator to assist travelling between main floor and basement.
- ❖ A kitchen with two refrigerators, two stoves, and a dishwasher (and no! I don't mean a volunteer on call 24/7). Adjacent to the kitchen is a storage room for tables and chairs, and a warming oven for caterers' use.
- ❖ Connections with ramps to the Vandorf P.S. and Bogarttown P.S. Once you're inside the main building, you can easily access both schoolhouses.

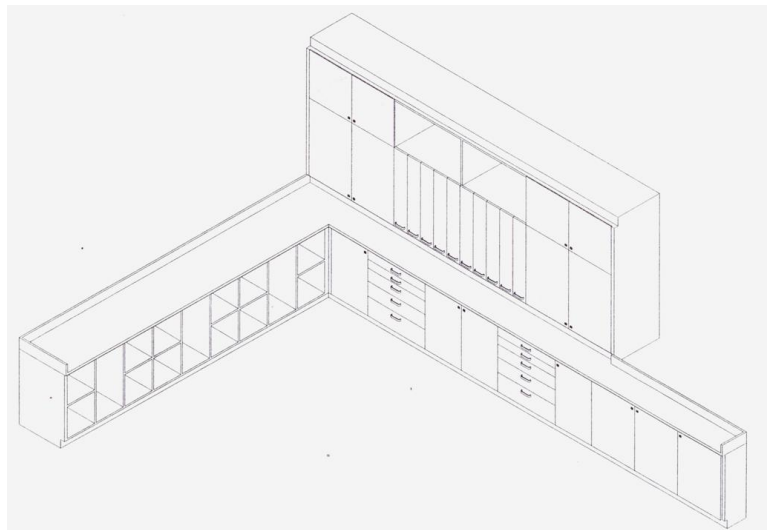

So aside from the typical challenges of the construction site -- randomly having no water, no heat, and/ or no phone or internet, we are enjoying being a part of this amazing new community treasure! We can't wait to start moving into the building and put our plans in place for the new spaces there. Please check out the website for floor plans, landscape drawings, and images of the construction. Photos are updated regularly!

"Making History Current" Fundraising Campaign

We are still accepting donations for our fundraising campaign and have some new ideas you may want to consider. We had initially thought that we were going to need substantial additional funds to purchase specialized Museum equipment, but we've been lucky enough with the way the budget for the project is progressing, that some of the pressure has been substantially reduced.

We ran a very successful event in the fall – "An Historic Girls Night Out" – and received amazing support from the local community for sponsorship – both in terms of cash donations and products to give away to our guests in their take home bags. The event included a silent auction and short play on the early women's suffragette movement. We have been asked about making this an annual event, so we are definitely filing that idea away in our plans.



For those of you interested in honouring a loved one and/or having your family remembered in our new building, there are a few options. Naming rights for specific spaces in the new building are available. (Please contact Dorie for more information on this.)



**REMINDER:
2011 Memberships
are now due!**

Membership benefits include -

- FREE access to the Museum's Archives
- FREE admission to the Car Show
- 20% discount on Adult & Children's Programs
- 10% discount on Gift Shop purchases
- Invitations to "Members Only" Events
- Membership Card and Newsletters

Remember memberships can also be given as gifts! This could be a great way to introduce friends to all your Museum has to offer!

As the new building approaches completion, staff will be looking at the possibility of revising the membership benefits. Some current items may be changed and some new items may be added. Stay tuned!

From Mastodons to Mantle

On February 24th, we were privileged to be able to hear a presentation from Dr. Ron Williamson at Nineteen on the Park as he updated the audience on the status of the Mantle Archaeological site and the artifacts found there. Dr. Williamson's company, Archaeological Services Inc. (ASI), is in the final stages of analysis of the items recovered from this site in southeast Whitchurch-Stouffville.

As you may know, the Mantle site was an early 16th century ancestral Wendat (Huron) village. The village covered 9 acres and over 150,000 artifacts have been excavated from the site. At its busiest, there may have been 2000 people in the village. The site housed close to 70 longhouses, surrounded by extensive corn fields. Close to 50% of the inhabitant's diet was maize and each inhabitant was consuming close to a pound of corn each day – that's a lot of corn needed by the village for survival. Over time, the land would have been depleted of nutrients needed to produce the corn – along with depletion of small game animals in the area - and so the village would have moved on.



Detailed human effigy from a ceramic smoking pipe.

The Canadian Museum of Civilization has expressed great interest in and will receive the collection of items once ASI has finished their studies. However, we are very lucky to be included in the provisions for this transfer. With the blessing of the Huron-Wendat nation, our Museum will be able to exhibit the artifacts in our new building. While no date has been set for this, we are looking at the possibility of summer of 2012.

Help with Car Show sponsorship!

We had our best year ever in terms of securing sponsorship for last year's Car Show. This year, we will be looking to repeat and perhaps even exceed last year's totals, so we will be continuing to approach local businesses to fill our slate of sponsors. If you would like to help with this project or if you are a local business interested in sponsorship, please let us know.

Are you in Spring Cleaning mode?



Many of you came forward with the towels that we requested last year. Thank you! This year we're looking for cereal boxes (the larger, the better) and regular weight knitting/ crocheting yarn (not the really thick stuff)! These will be used for our Education Programs in the fall.

2011 Exhibit News

2011 is the 40th anniversary of the creation of Regional government AND the merging of the former Village of Stouffville and the Township of Whitchurch into one municipality. To celebrate this, our changing exhibit – the first EVER in our new building with its dedicated exhibition space, will focus on this new community.

We are very excited to have this dedicated gallery and look forward to welcoming you later this summer to the exhibit!

Since our last newsletter, we installed two temporary exhibits in the Library case, one last June and October. We will again be exhibiting in May this year – stay tuned for the topic!

Weddings – The Exhibit



Our wedding exhibit showcased the history of Victorian wedding traditions. Using artifacts from the Museum's collection to

enhance the textual information, this exhibit was designed by 2010 summer student Juliana Garro.

Object of Reticule

Purse : \pɜrs\ Middle English *purs*, from Old English, modification of Medieval Latin *bursa*, from Late Latin, ox hide, from Greek *byrsa*.

In October the Museum presented an exhibit on

purses that displayed some beautiful samples from the collection and highlighted interesting facts about the use of handbags



throughout history. The exhibit was created by 2009 summer student Julia Jackson.

Spring Work Bee

Sunday May 29th
10 am – 3 pm.



Any time you can spare would be much appreciated – 1 hour, 2 hours, all day long.... Our main tasks will be to re-open the Barn for the season and tackle any other general tidying up of the site. We'll also do some clean up and plant the Log Cabin garden, if possible. Let us know if you can make it so we can be sure to have enough lunch!

Collections Notes

We received some wonderful donations in 2010. Here are some highlights:

- ❖ A scrapbook from Wesley United Church that includes memoires, family histories, letters and fantastic photographs! Interviews from individual members of the congregation provide an amazing community history.
- ❖ A xylophone made out of wood – complete with a mallet. We don't have a lot of smaller musical instruments in the collection, so these items are a neat addition. Also, items used primarily by children are rare as the items are usually so well used by the owners that they don't make it to a museum.



2010.10.1.1-2

- ❖ A gravestone for Robert Bogart - the infant son of John and Catherine – deceased Jan 17, 1817. This item has an interesting history and came as a transfer from the Elman Campbell Museum (Newmarket). From discussion with the Curator there, we believe this stone started out in the Bogart family burial ground and was discarded/ abandoned with other stones that were either carted away or thrown into the local pond by children years ago. Robert's body (along with 5 other family members) was moved to the Newmarket Cemetery after 1869 – when the cemetery opened – as happened with many other burials from smaller cemeteries. The bodies were interred in two plots belonging to M.W. Bogart.

- ❖ Child's chair, Jenny Lind style, 1860-80s. This lovely little chair is in excellent condition and has lovely wooden turned legs. This will make a wonderful addition to the Nursery in the Brown House!



2010.003.004

AND....

Last year, we told you about receiving a large number of desks from the Aurora Cultural Centre. These have temporary housing in the barn of volunteers Rick and Jeanne Preston. In the summer, we also received a full-sized, freestanding slate board which can be added to the schoolroom as part of our long term plans to return the Bogartown School to its full width.

AND FINALLY....

We have three new volunteers who are helping with artifact cataloguing and inventory: Valerie Saunders, Judi Williams, and Grace Cook! WELCOME! These capable helpers are quickly learning the "tools of the trade" as they work with staff and more seasoned volunteers Lynne Rubbens and Sharon McFadden. Any other interested people out there? Give us a shout! We'll have no problem keeping you busy!



Programming Notes

During construction we have continued to offer our Outreach programs as well as our Education Kit rentals to teachers. We are looking forward to getting students & teachers back on site in the new facility!

Currently we are working on creating the themed, hands-on baskets that will be available in numerous cubbies in the Discovery Room.

Each basket will contain items relating to a particular theme. Examples include: classic children's toys, farming/food Production, optical illusions, Stouffville then & now, farm animals, and the Victorian parlour. Each basket will contain hands-on items, graphics, and text. Fun for children & adults too!



Saturday June 4th
10:00 am – 4:00 pm

We are happy to report that we have 8 new sites and 4 returning favourites in our line-up for Doors Open Whitchurch-Stouffville 2011.

2011 Participating sites include: Ed's Hardware, Hollidge Tract - York Regional Forest Headquarters, Lionel's Farm, 6108 Main Street (private residence), Richmond Hill Live Steamers, Stouffville Lawn Bowling Club, Stouffville United Church, Wesley United Church, York County Bowmen, York-Durham Heritage Railway, Walter J. Smith Fire Station 5-1, Sangster Residence/Moksha Yoga Stouffville.

Once again you will be able to tune in to WhiStle Radio (102.7 FM) for LIVE updates during the event.

If you are interested in volunteering for Doors Open, please let us know and we'll do our best to place you at the participating site of your choice. You can volunteer for a full day or you can choose a morning or afternoon shift (3.5 hours). All volunteers receive an invitation to our Orientation Session in May (there will be food!).

Please visit www.doorsopenws.ca for more information.

General Gardens Update

As we are still not quite sure how the completion of the new building will impact our ability to plant and maintain our gardens this year, we are making tentative plans and being very flexible!



We have definitely lost a good chunk of the perennial bed on the south side of the Brown House, so we may only be able to re-store half of the former space there. We will probably have to wait until the new building's landscaping plan is implemented before we can move forward with future planning – such as the opening of a new (in this century anyway) garden space at the front of the Bogarttown.



Museum Schedule for 2011!

Mark your calendars now and don't forget to spread the word to your neighbours and friends!!



- Apr 10 Pancake Brunch at Vandorf C.C.
- May Exhibit at the Library
- May 9 May Day Play Day PA Day workshop
- May 20 Switch to Summer hours
Wed-Sun, 10 am – 5 pm
- May 29 Spring Volunteer Work Bee
- June 4 Doors Open Whitchurch-Stouffville
- July 2 Strawberry Festival on Main Street
(Museum closed)
- Aug 14 38th Annual Car Show (raindate: Aug 21)
- Sept 7 Switch to Winter Hours
Monday-Friday, 1 – 5 pm
- Sept 24 History Hands-On with Apples
- Oct 14 Volunteer Appreciation Dinner
- Oct 16 Fall Volunteer Work Bee
- Oct 22 History Hands-on with Pumpkins
- TBD PA Day Holiday Workshop
- Nov 25 31st Annual Victorian Tea
- Dec 10 "A Candlelight Christmas" PM tour



From the Archives:

From the Tribune, Dec. 7, 1888:

Light Wanted. On Sunday evening last we noticed that a few of our more considerate citizens had placed light in their window, which we are sure were greatly appreciated by pedestrians. It certainly looks rather primitive to see people in a town the size of Stouffville obliged to carry lanterns to church in order to avoid breaking their necks. Why can't we have street lamps?

From the Tribune, March 8, 1889

Light on the Subject. A petition is being calculated for signatures requesting Council to provide twelve street lamps for the village. The project is a commendable one and one we trust will meet with the hearty support of the rate payers.

From the Tribune, Nov 16 1888

Accident in Lemonville. While the people were wending their way home from the temperance meeting the other night, one of the company, a married lady, had the misfortune to miss her footing in the dark, and stepped off the end of the bridge into the pond, where she experienced a refreshing bath. After making a big splash in the water, she soon found her way out while her husband stood on the bridge expressing his sympathy for her. The lady also sprained her ankle in the fall and had to be taken home in a buggy. The married citizens of our hamlet should build a railing along such dangerous places.



For performing arts events & activities in Town, please visit www.nineteenonthepark.ca.

For visual arts programs & exhibitions, please visit www.latchamgallery.ca.